



USER MANUAL

EN

Tempnote® V1.0
Single-Use Temperature Data Logger

Tempnote V1.0/2024



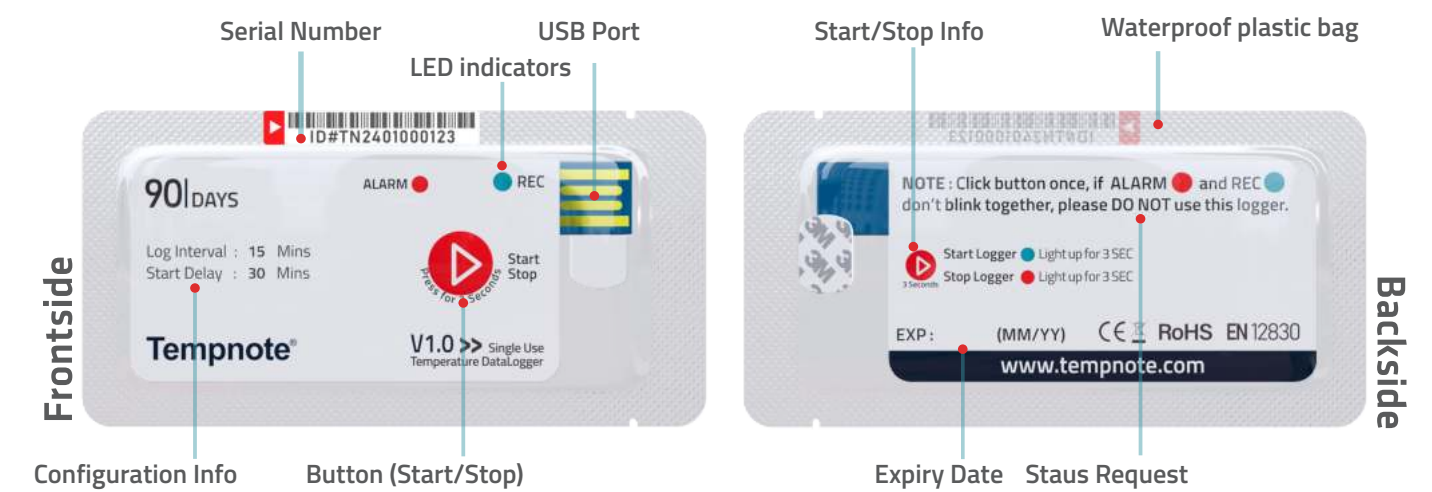

1. Press button for 3 Seconds to START
2. Add started Tempnote® V1.0 to your shipment
3. Connect stopped Logger directly to USB Port
4. Automated PDF Report with all Details

🔍 Technical Specifications

Recording Option	Single Use	Certifications	EN12830, CE, RoHS
Temperature Range	-30°C to +70°C	Validation Certificate	Hardcopy in Package
Temperature Accuracy	± 0.5 °C (-30°C to +70°C)	Report Generation	Plug - N - Play
Temperature Resolution	0.1 °C	Report Format	Auto Generated PDF
Data Storage Capacity	10,000 Readings	Password Protection	Optional on request
Shelf Life / Battery	18 Months / CR2032 Button Cell	Connection Interface	USB 2.0, A-type
Recording Interval	15 minutes (standard, customizable)	Alarm Configuration	High and Low Alarm
Start Delay	30 minutes (standard, customizable)	Reprogrammable	Tempnote Analyzer Software
Recording Duration	upto 90 Days (customizable)	Accessories Incl.	Shipping Documents Calibration Certificate
Startup Mode	Button or Software	Please visit www.tempnote.com to download Calibration Certificate online	
Protection Class	IP67 / NEMA 6		
Dimension	67 mm x 28 mm x 5.5 mm		
Weight	Approx 13 Gms		

Operation Instructions

1



Start

LONG PRESS BUTTON FOR 3 SECONDS

Keep button long pressed for minimum 3 seconds to start recording. Then **GREEN** LED will light up for 3 seconds, which indicates a successful starting.

2



Stop

LONG PRESS BUTTON FOR 3 SECONDS

Keep button pressed for minimum 3 seconds to stop recording. Then **RED** LED will light up for 3 seconds which indicates a successful stopping.

3



Report

PLUG LOGGER'S USB TO COMPUTER USB PORT

Tear off plastic cover and plug the logger to USB port of computer. PDF report will be autogenerated which can be found in the device's folder.

Operation Indication

Start / Stop

Status	Action	LED confirmation
Start Logger	3 sec Long Pressing button	RECORD LED Light Up for 3 seconds
Stop Logger	3 sec Long Pressing button	ALARM LED Light Up for 3 seconds

Status Request by pushing Button 1 time

Status	Action	LED confirmation
Not Started	Push button 1 time	RECORD LED + ALARM LED flashing 1 time
Recording - OK	Not Required	RECORD LED flashing 1 time every 10 seconds
Recording - Alarm	Not Required	ALARM LED flashing 1 time every 10 seconds
Stopped- OK	Push button 1 time	RECORD LED flashing 1 times
Stopped- Alarm	Push button 1 time	ALARM LED flashing 1 times



Notes

- 🔌 When Tempnote® V1.0 logger is stopped and connected to computer the first time, both LEDs are flashing to indicate the PDF reports are in process of generation. At this time, please DO NOT unplug the logger until both LEDs are ON, which indicates the finished PDF report generation.
- 🔌 A stopped Tempnote® V1.0 logger cannot be started again.
- 🔌 Do not place Tempnote® V1.0 logger into corrosive liquid or expose to direct heat.
- 🔌 The battery of Tempnote® V1.0 logger is a non-replaceable CR2032 lithium battery.
- 🔌 Store Tempnote® V1.0 logger under room temperature conditions and do not use once it is expired.
- 🔌 Please dispose Tempnote® V1.0 loggers in accordance with local laws and regulations (electronic waste).
- 🔌 To reprogram Tempnote® V1.0 logger, Tempnote Analyzer will be required, download it from www.tempnote.com

1:1 Time Zone Conversion Table

The standard time of lite is UTC + 05:30 To match your local time, please note the time difference.

Value	Time Zone
(UTC + 14:00)	Line Islands, Kiritibati
(UTC + 13:00)	Nuku'alofa
(UTC + 12:00)	Auckland, Wellington, Fiji, Karnchatka, Marshall Is.
(UTC + 11:30)	Norfolk Island
(UTC + 11:00)	Magadan, Solomon Is., New Caledonia
(UTC + 10:30)	Lord Howe Island
(UTC + 10:00)	Brisbane, Canberra, Melbourne, Sydney, Hobard, Vladivostok, Guam, Port Moersby
(UTC + 09:30)	Darwin, NT, Australien, Adelaide, SA, Australien
(UTC + 09:00)	Yakutsk, Osaka, Sapporo, Tokyo, Seoul, Adelaide, Darwin
(UTC + 08:00)	Perth, Taipei, Kuala Lumpur, Singapore, Irkutsk, Ulaan Bataar, Beijing, Chongqing, Hong Kong, Urumqi
(UTC + 07:00)	Krasnoyarsk, Bangkok, Hanoi, Jakarta
(UTC + 06:30)	Myanmar, Rangun, Myanmar, Kokosinseln
(UTC + 06:00)	Astana, Dhaka, Yangon (Rangoon), Almaty, Novosibirsk
(UTC + 05:45)	Nepal, Kathmandu
(UTC + 05:30)	Indien, Neu Delh, Mumbai, Kalkutta, Adamanen-Inseln, Nicobar-Inseln
(UTC + 05:00)	Ekaterinburg, Chennai, Kolkata, Mumbai, New Dehli, Kathmandu, Islamabad, Karachi, Sri Jayawardanepura, Tashkent
(UTC + 04:30)	Afghanistan
(UTC + 04:00)	Kabul, Abu Dhabi, Muscat, Yerevan, Baku, Caucasus Standard Time
(UTC + 03:30)	Teheran, Iran
(UTC + 03:00)	Moscow, St. Petersburg, Volgograd, Tehran, Tbilisi, Nairobi, Baghdad, Kuwait, Riyadh
(UTC + 02:00)	Minsk, Cairo, Helsinki, Kyiv, Riga, Sofia, Tallinn, Vilnius, Athens, Bucharest, Istanbul, Jerusalem, Amman, Beirut, Harare, Pretoria
(UTC + 01:00)	Brussels, Copenhagen, Madrid, Paris, West Central Africa, Sarajevo, Skopje, Warsaw, Zagreb, Belgrade, Bratislava, Budapest, Ljubljana, Prague
(UTC ± 00:00)	Dublin, Edinburgh, Lisbon, London, Monrovia, Reykjavik, Casablanca(standard time of RC-18/19)
(UTC - 01:00)	Azores, Cape Verde Is.
(UTC - 02:00)	Mid-Atlantic
(UTC - 03:00)	Buenos Aires, Brasilia, Greenland, Monetvideo, Newfoundland, Georgetown
(UTC - 03:30)	Newfoundland, Kanada, Surinam
(UTC - 04:00)	Atlantic Time (Canada), Manaus, Santiago, La Paz, Caracas
(UTC - 05:00)	Eastern Time (US & Canada), Bogota, Lima, Quito, Rio Branco
(UTC - 06:00)	Central Time (US & Canada), Guadalajara, Mexico City, Monterrey, Central America
(UTC - 07:00)	Mountain Time (US & Canada), Arizona, Chihuahua, La Paz, Mazatlan
(UTC - 08:00)	Pacific Time (US & Canada)
(UTC - 09:00)	Alaska
(UTC - 10:00)	Hawaii
(UTC - 11:00)	Midway Island, Samos
(UTC - 12:00)	International Date Line West